



User Guide Supplement Mac Classifier

September 2021



Copyright Terms and Conditions

Copyright Help/Systems LLC and its group of companies.

The content in this document is protected by the Copyright Laws of the United States of America and other countries worldwide. The unauthorized use and/or duplication of this material without express and written permission from HelpSystems is strictly prohibited. Excerpts and links may be used, provided that full and clear credit is given to HelpSystems with appropriate and specific direction to the original content. HelpSystems and its trademarks are properties of the HelpSystems group of companies. All other marks are property of their respective owners.

202109130200

Table of Contents

About this Guide	5
Differences between Classifier for Mac and Classifier for Windows	6
Features	6
Other Limitations	8
Using Mac Classifier	9
Apply Rules to Applications	9
Select a Classifier Label	10
Add Favourites	11
Policy Check Dialog	11
Supported Features in Mac and Windows	13
Common Label Handling Features	13
Common Label Interface Options	14
Audit Settings	15
Languages	15
View Client Licence Status	15
Image Library	15
User Message Library	15
User Interface Library	15
Selector Library	15
Marking Library	16
Content Library	16
Condition Library	16
Classifier Application Settings	16
Label Locations	18
General Settings	18
Policy Features	20
Rules	21
Clearance Features	24
Configuration Deployment	24
Classifier Configurer	25

Manage your Configuration and Software	25
Label Propagation Mechanisms	25
Boldon James Tracing and Event logging	26
Managed Logging	26
Native Logging	27
Native logging (Sierra)	27
Native logging (High Sierra)	28
Create and delete Diagnostics dictionary	28
Event Logging	28
Working with Windows Classifier Applications	29
Auditing Notes	30

About this Guide

Mac Classifier adds additional features to Microsoft Outlook emails, together with Word, Excel, and PowerPoint documents. Mac Classifier offers a subset of the features supported by the equivalent Classifier product for Windows.

This guide summarizes the differences between Classifier applications for Mac and for Windows, and provides a detailed comparison between the products in these two environments.

Differences between Classifier for Mac and Classifier for Windows

Features

The following table provides a high-level summary of the features supported by Classifier in the Mac and Windows environments.

Feature	Supported Environments
McAfee HDLP integration (Outlook only)	Windows
Common Label handling features	Windows and Mac
Label Selection dialog	Windows and Mac
Label Options	Windows
Favourites	Windows and Mac
Recently used labels	Windows
Folder View Labelling	Windows
Portion Mark	Windows
Control of options shown and ribbon location	Windows
Remove Classifier options from ribbon bar	Windows
Show help button in ribbon bar	Windows
Global settings	Windows and Mac
Configuration settings – Application Settings , Label Locations , General Settings	Windows and Mac
One or more policies may be defined	Windows and Mac
Users see a policy view of the features	Windows and Mac
Outlook specific policy	Windows
Policy control of Rules per application (Rules Supported)	Windows and Mac
Challenge option	
Policy UI controls	Windows and Mac

Display selector values as buttons (Single selection list only)	Windows and Mac
Show Selector captions in ribbon bar	Windows
Suggested Classifications	Windows
Additional selectors (no specific limit is imposed, but Classifier testing has exercised up to 12)	Windows and Mac
Label Selection interface Tabs	Windows and Mac
Single selection list	Windows and Mac
Multiple selection list	Windows and Mac
Text entry selector	Windows and Mac
Date picker selector	Windows and Mac
Date offset list selector	Windows and Mac
Single Click	Windows and Mac
Assisted Labelling	Windows and Mac
Marking Formats with Hyperlinks	Windows and Mac
Environment Variables in Marking Formats	Windows
Document properties in Marking Formats (Office)	Windows and Mac – but Status only available in Windows
Email properties in Marking Formats	Windows and Mac – but Sensitivity only available in Windows
Use plain text style	Windows and Mac
User features controlled by Classifier Policy	Windows and Mac
Configuration in Active Directory or File store or via Web	Windows and Mac – but Active Directory only available in Windows
Extensive audit features	Windows and Mac
Dynamic Clearances	Windows
SMTP domain clearances	Windows and Mac
User Interface Library	Windows and Mac
Content Library	Windows
Conditions Library	Windows

Multiple Language support	Support for languages other than English can be found in the Release Notes.
Localisation of selector value Name, Tooltip, Portion, Alternate Name /2/3 (Single selection list only)	
Licence control of feature availability	Windows and Mac
Image Library	Windows and Mac
Site control of user messages	Windows and Mac
Microsoft Office types (Word, Outlook etc.)	Windows and Mac
JPEG (manual configuration)	Windows and Mac
HTML (manual configuration)	Windows and Mac
Open Office file types (manual configuration)	Windows and Mac
AUTOCAD files (DWG and DXF)	Windows
Visio Files	Windows

Other Limitations

- Do not use the Touchbar on MacBook Pro to send mail as the Classifier functionality is not invoked.
- Word Headers and Footers do not support font changes in the middle of a word or support text boxes.
- Excel Headers and Footers do not support multiple fonts (colour/face/size), or support different First Page/Odd/Even Page options. This is a limitation of the Mac Office application. Classifier Administration limits the rule options available accordingly.
- Outlook in the Mac environment does not allow writing email transport headers (X-Headers). For labelling interoperability, all Classifier enabled email clients should be configured to add a label as a complete visual marking and all clients should be configured to use Label Locations to read the label from the same visual marking.
- Outlook in the Mac environment does not support the expiry time property or sensitivity property that the Windows version does support.
- The Send Later option in Outlook (Office 365) is disabled in the Mac environment but is available in the Windows environment as the Delay Delivery option.
- The Classifier client for Outlook in the Mac environment supports labelling of email messages only. For instance, Classifier for Mac does not support the labelling of tasks or appointments.

Using Mac Classifier

Mac Classifier runs as a service and automatically starts whenever a user logs on to the Mac, adding an icon to the macOS menu bar.



Clicking the icon allows you to view and organize Favourites and information about Classifier.

If there is a Classifier label associated with the currently active application, the label's summary marking appears alongside the Classifier icon in the menu bar.



By default, summary markings longer than 50 characters will be truncated and terminated with the ellipsis (...) character. Hovering over the menu title will display the full label in a pop-up.

Apply Rules to Applications

The Classifier Administration Rule Wizard interface configures Rules for Mac Classifier. Additional choices appear for the Mac Office applications when you apply a suitable Mac Classifier licence:

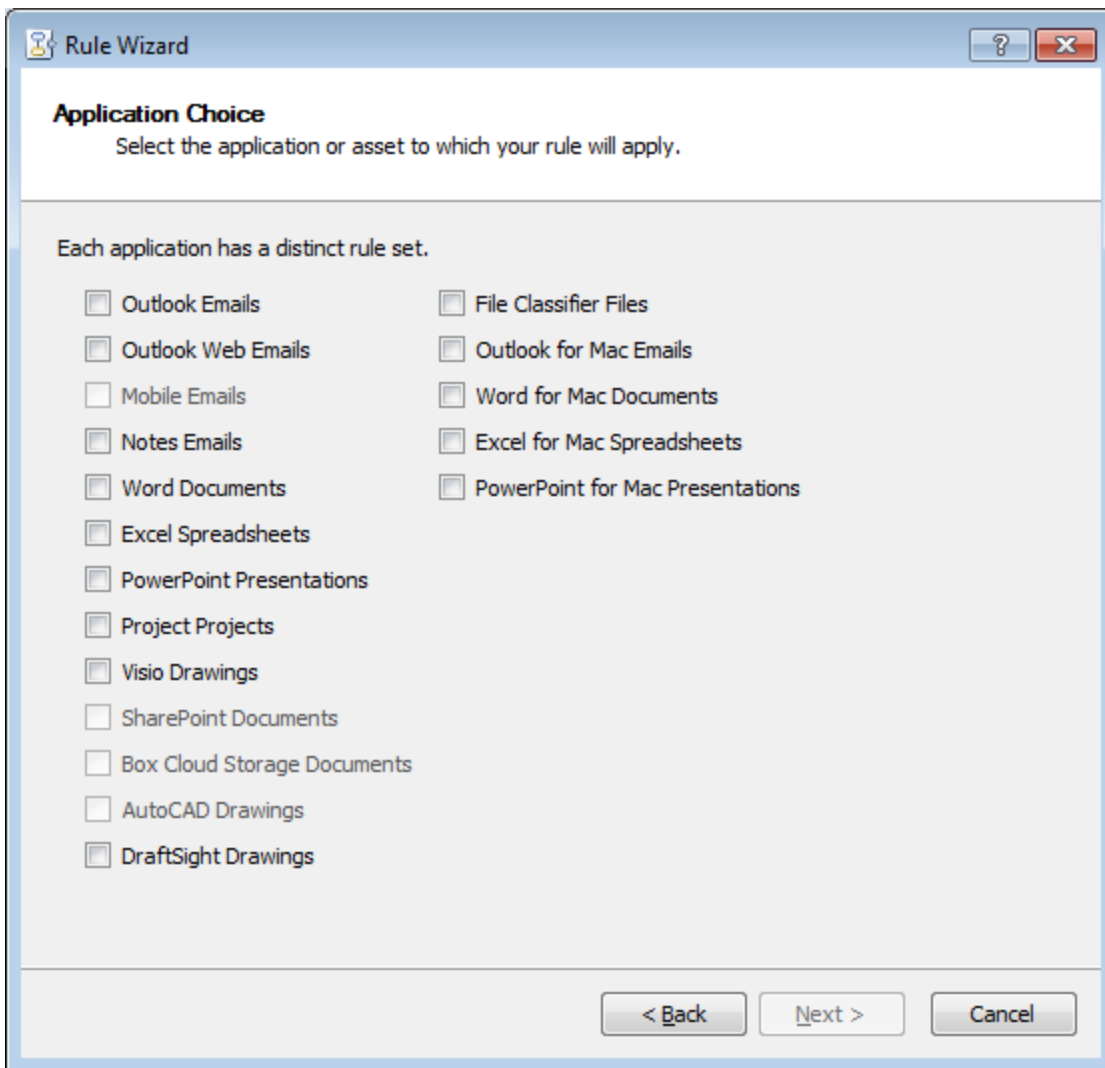

Select a Classifier Label

1. Select either the icon as shown on the left for Word, Excel, or PowerPoint documents, or the icon on the right for email.



A Label selection dialog appears that presents the currently selected label value and the available selectors and selector values.

2. Select a classification and click **Continue**.

NOTE: The Help button only appears in the label dialogs below if there is a valid URL for your labelling help site configured in the Classifier General settings.

If your summary bar show NO LABEL, click it to access to the full label selection dialog.

NOTE: If you switch backwards and forwards between single-click and full label dialog, when you close the dialog, it will remember the last mode used, and use the same mode when you re-open it.

Add Favourites

An Administrator can make Favourites available to users by using the **Display of Favourites** General setting.

If enabled, Favourites management options are available below the Classifier screen icon menu and the user can choose Favourites from the Classification Label dialogue.

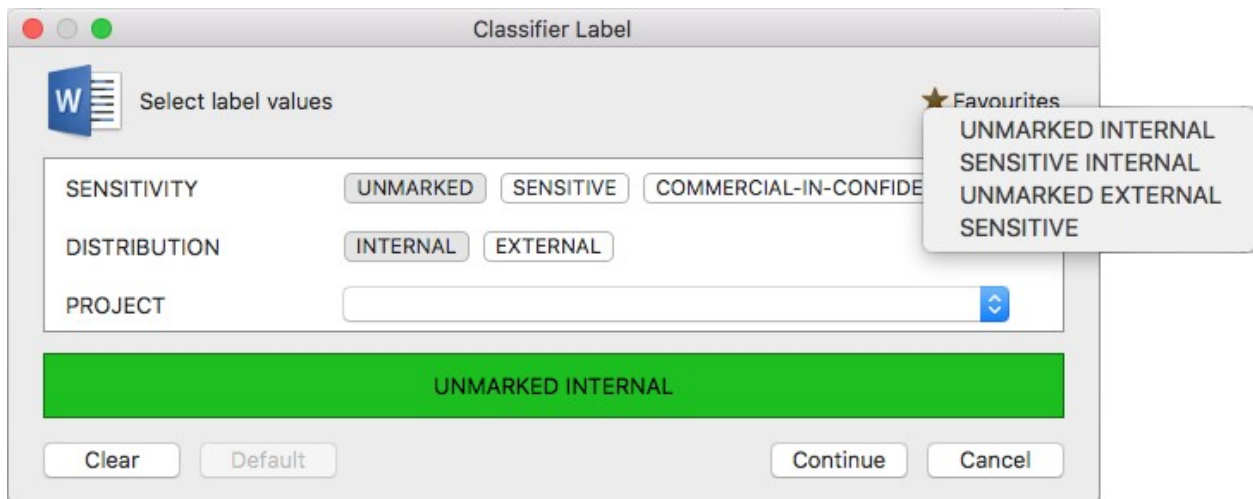

You can organise the order of the Favourites by clicking the Classifier icon in the menu bar.

Policy Check Dialog

If you save a document or send an email that is not classified, the Policy Check dialog may appear as per the following example:

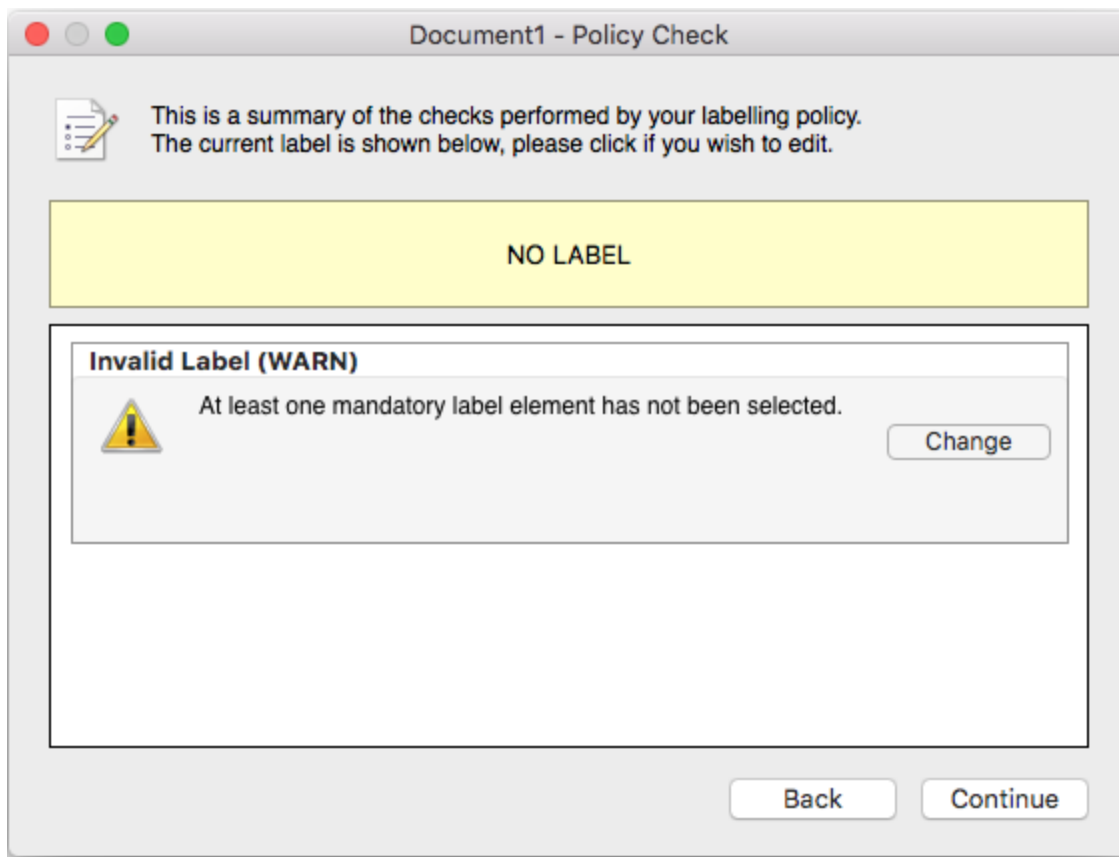

Supported Features in Mac and Windows

An entry of Yes means the feature is supported in both the Mac and Windows environment.

An entry of No means the feature is not supported in the Mac environment; it is only available in the Windows environment.

Common Label Handling Features

Feature	Supported by Mac or Windows or both?
Label Propagation	Generally, this works the same as under Windows. However, the SISL label cannot be written to messages, and therefore other features must be used (Subject / LLOT) to allow receiving applications to determine the label. Alternatively, Exchange Classifier or Exchange Transport rules can be used.
Printable Labels Header / Footer / Watermark/ Field Codes / Portion Marks	<ul style="list-style-type: none"> • Text Watermark is not supported under Word. • Field Code markings are not supported. • Portion Marking is not supported.
FLOT / LLOT Start or End of Subject / Portion Marks	<ul style="list-style-type: none"> • Portion Marks are not supported.
Recognition of Received Label values	See label propagation above.
Mandatory Selectors	Both
Default Label values	Both
Insert Marking as Field Code (Word only)	Windows

Document Properties (Office Classifier)	Both
Templates	Both

Common Label Interface Options

Option	Supported by Mac or Windows or both
Label Selection Interfaces (Selectors and Values presented)	Both
Ribbon Bar	Windows
Label Selection dialog	Both
Favourites	Both
Portion Mark	Windows
Recently Used Labels and Portion Marks	Windows
Single Click Operation	Both
Assisted Labelling Operation	Both
Tabs (defined via a policy)	Both
Label Options Clear Default	-
Link to Site Defined Help About Classifier	Clear is supported on Label dialog. Default is supported on Label dialog. Link to site defined Help is supported. About Classifier is available from the macOS menu Show Summary Marking is not supported.
Show Summary Marking	
Folder View Labelling Operation	Windows
Text presented to the user can be configured	Both

Audit Settings

Mac Classifier auditing operates as described in the main Classifier Administration Server User Guide, but the Auditing will be directed as per [BJ Tracing and Event Logging](#).

The following audit settings are not relevant in the Mac environment:

- Always use SMTP addresses
- Author label change check
- Content Check
- Disable reply to all check
- File label addition / Change / Removal (File Classifier)
- Label Folder View
- Originator / Recipient Clearance check
- Recipient list addition check
- Suggested classification check
- Test mode auditing

Languages

The default language is English. User Interface definitions can be configured. See the Release Notes for the languages currently supported.

View Client Licence Status

Not supported in the Mac environment.

Image Library

Supported in the Mac environment.

User Message Library

Supported in the Mac environment.

User Interface Library

Supported in the Mac environment.

Selector Library

Supported in the Mac environment.

NOTE: Changes made to the text selector are applied when you move away from the field, i.e. tabbing or clicking somewhere else. This differs from Windows which updates as you type.

Marking Library

Supported in the Mac environment subject to:

- Word and Excel Headers/Footers do not support multiple fonts (colour/face/size).
- The Status document property is not supported.
- Environment variables in Marking formats are not supported.

Content Library

Content checking is not supported in the Mac environment.

Condition Library

The use of conditions is not supported in the Mac environment.

Classifier Application Settings

The following table lists the Classifier Application settings and if they are supported, not supported, or not applicable to the application.

Setting	Outlook	Word	Excel	PowerPoint
Allow classification of meeting requests and appointments	No	N/A	N/A	N/A
Allow classification of tasks	No	N/A	N/A	N/A
Allow label change on protected documents	N/A	Yes	N/A	N/A
Allow manual upgrade when sending messages	Yes	N/A	N/A	N/A
Always use Distribution List clearances	No	N/A	N/A	N/A
Apply Headers/Footers when label is changed	N/A	N/A	Yes	N/A
Apply Headers/Footers when workbook is saved	N/A	N/A	Yes	N/A

Automatically elevate email label (Note on Send only – not on Attach)	Yes	N/A	N/A	N/A
Automatically update Label fields	N/A	Yes	N/A	N/A
Custom format for 'Insert label'	N/A	No	N/A	N/A
Custom format for 'Label' column	No	N/A	N/A	N/A
Ensure attachment markings are consistent	Yes	N/A	N/A	N/A
Ensure label dominates all portion markings	No	N/A	N/A	N/A
Folder View Labelling	No	N/A	N/A	N/A
Folder View column name	No	N/A	N/A	N/A
Folder View column populate on start-up	No	N/A	N/A	N/A
Force Summary Marking in task pane	N/A	No	No	No
Include embedded images when performing attachment checks	No	N/A	N/A	N/A
McAfee Host DLP marking	No	N/A	N/A	N/A
McAfee Host DLP scan	No	N/A	N/A	N/A
Portion Marking	No	No	No	No
Process rules when exporting	N/A	Yes	Yes	Yes
Process rules when printing	N/A	Yes	Yes	Yes
Process rules when saving	N/A	Yes	Yes	Yes
Show Classifier on ribbon when reading	No	N/A	N/A	N/A
Show 'Insert Label' context menu	N/A	No	N/A	N/A
Show label dialog on Save or Print	N/A	Yes	Yes	Yes
Show label dialog on send	Yes	N/A	N/A	N/A
Show label dialog style	Yes	Yes	Yes	Yes
Show label dialog when mandatory label	Yes	Yes	Yes	Yes
Show Summary Marking in task pane	No	No	No	No

Show Summary Marking in title bar	N/A	No	No	No
Update markings when indicated	N/A	Yes	Yes	Yes
Use default label when replying to unmarked emails	Yes	N/A	N/A	N/A
Use From field for Originator clearance	No	N/A	N/A	N/A
Warn if file contents cannot be accessed	No	N/A	N/A	N/A
Watermarks use marking format font	N/A	No	N/A	N/A

Label Locations

All Classifier applications should be configured to add a complete visual marking for the label and use Label Locations to determine the label by reading from that same visual marking. Consider the following:

- A Classifier Label in the Document Property or Document Custom Property is supported.
- A Classifier Label in the First Line of Text (FLOT), Last Line of Text (LLOT) and email subject are supported.
- A Classifier Label cannot be set in an email transport header (X-Header), but X-Header values in received messages can be read.

IMPORTANT: Outlook in the Mac environment does not allow writing email transport headers (X-Headers). For labelling interoperability, all Classifier-enabled email clients should be configured to read and write a label in the First Line of Text (FLOT), Last Line of Text (LLOT) or email.

General Settings

The following table lists the General settings and if they are supported, not supported, or not applicable to the application.

Setting	Outlook	Word	Excel	PowerPoint
Automatically expand policy warning messages (Always expanded in the Mac environment)	No	No	No	No
Check Label Locations first	Yes	Yes	Yes	Yes
Classification History	N/A	No	No	No

Classification History Display (2010 or later)	N/A	No	No	No
Classifier ribbon group location	No	No	No	No
Content checking - case sensitive	No	No	No	No
Content checking - include document properties	No	No	No	N/A
Custom format for 'Classifier Auditing'	Yes	Yes	Yes	Yes
Custom format for 'Label Summary' custom document property	N/A	Yes	Yes	Yes
Custom format for Portion marking	No	No	No	No
Custom format for Summary Markings	Yes	Yes	Yes	Yes
Disable OK on Label dialog if mandatory values are missing	Yes	Yes	Yes	Yes
Display of Favourites button	Yes	Yes	Yes	Yes
Display of Label Dialog launch button	No	No	No	No
Indicate mandatory selector check failures	No	No	No	No
Prompt for reason for ignoring policy warning - Superseded by Challenge options	N/A	N/A	N/A	N/A
Show 'Help' button on ribbon bar	No	No	No	No
Show labeller 'Clear' button (Label dialog only)	Yes	Yes	Yes	Yes
Show labeller 'Default' button (Label dialog only)	Yes	Yes	Yes	Yes
Single Click best match	Yes	Yes	Yes	Yes
Summary Marking as black text on a white background	No	No	No	No
Text displayed when a distribution list fails to expand	Yes	N/A	N/A	N/A
Text displayed when attachment check failed to complete	Yes	N/A	N/A	N/A

Text displayed when Folder View labelling fails	No	N/A	N/A	N/A
Text displayed when mandatory label is absent	Yes	Yes	Yes	Yes
Text displayed when originator check failed to complete	No	N/A	N/A	N/A
Text displayed when prompting for a reason for ignoring policy warnings - Superseded by Challenge options	N/A	N/A	N/A	N/A
Text displayed when recipient check failed to complete	Yes	N/A	N/A	N/A
Text displayed when RMS protection failed to complete	No	No	No	No
Text displayed when S/MIME application failed to complete	No	N/A	N/A	N/A
Text to display for notifying of policy checks performed	Yes	Yes	Yes	Yes
Text to display for resolution of policy issues	Yes	Yes	Yes	Yes
Text to display if attachment markings are inconsistent	Yes	N/A	N/A	N/A
Text to display if no marking is available	Yes	Yes	Yes	Yes
URL for your labelling help site (the path will be subject to Mac environment syntax rules e.g. http://intranet/corporate/default.aspx , else the file will download rather than display the contents). If the link is not valid, then the Help button will not be displayed in the label dialog.	Yes	Yes	Yes	Yes

Policy Features

Feature	Supported by Mac or Windows or both
---------	-------------------------------------

Policy Management	Both
Maximum number of labels to show	Windows
User Selectable Default Classification	Windows
Use Assisted Labelling	Both
Use Single Click with pre-defined labels	Both
Show selector captions on the ribbon bar	Windows
Where possible wrap buttons at	Windows
Policy Label UI	Both
Selector Properties Single Selection / Multiple Selection / Text entry / Date Picker /Date offset list	Both
Retained selectors	Both
Suggested Classifications	Windows
Rules Management	Both

Rules

The following table lists the Rules and if they are supported, not supported, or not applicable to the application.

Rules	Outlook	Word	Excel	PowerPoint
Add a FLOT	Yes	N/A	N/A	N/A
Add a LLOT	Yes	N/A	N/A	N/A
Add to Subject here	Yes	N/A	N/A	N/A
Add this X-Header (Mac Outlook does not support writing to email transport headers)	No	N/A	N/A	N/A
Add attachment list (Attachment list format)	Yes	N/A	N/A	N/A
Add these addresses	Yes	N/A	N/A	N/A

Add a textbox on the header	N/A	No	N/A	N/A
Add a textbox on the footer	N/A	No	N/A	N/A
Add a textbox on the top	N/A	N/A	N/A	No
Add a textbox on the bottom	N/A	N/A	N/A	No
Add a header here (marking format limitations)	N/A	Yes	N/A	N/A
	N/A	Yes	N/A	N/A
Different 1st page	N/A	Yes	N/A	N/A
Different odd/even pages				
Add a header (marking format limitations)	N/A	N/A	Yes	Yes
	N/A	N/A	No	N/A
Different 1st page	N/A	N/A	No	N/A
Different odd/even pages				
Add a footer here (marking format limitations)	N/A	Yes	N/A	N/A
	N/A	Yes	N/A	N/A
Different 1st page	N/A	Yes	N/A	N/A
Different odd/even pages				
Add a footer (marking format limitations)	N/A	N/A	Yes	Yes
	N/A	N/A	No	N/A
Different 1st page	N/A	N/A	No	N/A
Different odd/even pages	N/A	N/A	No	N/A
Smart selection				
Add an image into header	N/A	Yes	N/A	N/A
Add an image to top of page	N/A	N/A	N/A	Yes
Add an image into footer	N/A	Yes	N/A	N/A
Add an image to bottom of page	N/A	N/A	N/A	Yes
Add a watermark	N/A	No	N/A	N/A
Add an image as a watermark	N/A	Yes	N/A	N/A
Add this document property	N/A	Yes	Yes	Yes
Add this custom document property	N/A	Yes	Yes	Yes
Apply S/MIME security	No	N/A	N/A	N/A

Apply this Category	Yes	N/A	N/A	N/A
Apply a delivery report request	No	N/A	N/A	N/A
Apply a read receipt request	No	N/A	N/A	N/A
Apply this priority value (Importance under Windows)	Yes	N/A	N/A	N/A
Apply this sensitivity value (not supported by Outlook)	No	N/A	N/A	N/A
Apply this expiry value (not supported by Outlook)	No	N/A	N/A	N/A
Apply this RMS policy (not supported by Outlook or Office)	No	No	No	No
Check these mandatory selectors	Yes	Yes	Yes	Yes
Check for Author label change	N/A	No	No	No
Check for label change	Yes	Yes	Yes	Yes
Check for the high-water mark	Yes	N/A	N/A	N/A
Check clearance for recipients (email domain clearance only)	Yes	N/A	N/A	N/A
Check clearance for originator	No	N/A	N/A	N/A
Check subject length does not exceed	Yes	N/A	N/A	N/A
Check subject length exceeds	Yes	N/A	N/A	N/A
Check message size	Yes	N/A	N/A	N/A
Check content for this	No	No	No	No
Check number of recipients	Yes	N/A	N/A	N/A
Check for these recipients	Yes	N/A	N/A	N/A
Check for Reply to All response	No	N/A	N/A	N/A
Check for use of default label	Yes	Yes	Yes	Yes
Check with the user	Yes	Yes	Yes	Yes
Check these selectors for expired dates	Yes	Yes	Yes	Yes
Check for additional recipients on reply or forward	No	N/A	N/A	N/A

Check for these unlabelled attachments	Yes	N/A	N/A	N/A
Check for a suggested classification	No	No	No	No

NOTE:

1. If you create a document with a Classifier Header / Footer and then perform a Mail Merge, the header/footer is updated with the current marking. Any subsequent change to the classification will have no effect on the header/footer presented. This is different to Classifier in the Windows environment which is able to maintain the header/footer information as a field code and thereby respond to subsequent changes in classification. In the Mac environment, Classifier is unable to modify the standard Mail Merge sequence.
2. If a Mail Merge is performed in word, and the document does not yet contain any header/footer, then Classifier add header/footer rules may add an empty paragraph to the header/footer (blank line).
3. A Check these mandatory selectors rule is not triggered when saving embedded documents.
4. Classifier for Mac Word does not recognize text boxes in headers or footers nor will it attempt to write text boxes to headers or footers. For instance, if text-boxes have been placed in the document by windows classifier, Mac Classifier will not be able to update the label in that text box when a new label is applied to the document.

Clearance Features

Feature	Supported by Mac or Windows or both
Domain Clearance	Both
	<p>NOTE: Distribution lists are not expanded, and the distribution list address will be used if Domain Clearance is enabled.</p>
Dynamic Clearances	Windows

Configuration Deployment

A Configuration must be retrieved from file store or web. It cannot be retrieved from the Windows Active Directory.

The Classifier windows registry settings are supported by extension of the Classifier.plist file content. The installation provides a sample file. Refer to the Release Note for further details.

Classifier Configurer

If you want to make changes to your configuration

1. Open the Classifier.plist file located at /Library/Application Support/Boldon James/.
2. Make any changes and click **Update** to save them.
3. Click **Test** to perform validity checks on the contents.

NOTE: Path names within the plist file are case sensitive. The plist file contains XML so certain characters must be escaped. For example, the ampersand character should be & and less-than character should be < If you use the Classifier Configurer tool to edit settings (rather than hand editing the XML), these characters will be automatically handled.

The following Classifier registry entries are not supported in the Mac environment:

- OutlookPolicy – use standard policy
- AllowClassificationHistoryClear – Classification history not supported
- HWMCheckEmbeddedOfficeDocuments – Embedded documents are not checked.
- IgnorePasswordProtectedZips – Warnings will appear if relevant.
- None of the settings to Auto Enable Microsoft Office Header / Footer controls are supported. The defaults apply.

If a remote server holds the Classifier configuration, then establish a suitable share to the remote server (e.g. \\apps\Dispoint). This share appears below /Volumes and the entry in classifier.plist can be set to /Volumes/Dispoint/Classifier Configuration for example.

Manage your Configuration and Software

Use Industry standard software management tools such as Casper to manager your Classifier software (providing features equivalent to Windows Group Policy distribution).

Label Propagation Mechanisms

Label propagation mechanisms are supported, but with some limitations.

- Unlike the Windows Outlook product, Mac Outlook does not support writing to email transport headers. Hence, Classifier cannot store any label information in x-headers. For labelling interoperability, Mac Classifier (Outlook) should be configured to add a complete visual marking for the label and all Classifier email clients should be configured to read the label from multiple Label Locations. Alternatively, Exchange Classifier or Exchange mail flow rules might be deployed to add such markings to Email from Windows to Mac environments.
Propagation of properties (e.g. Author, Subject, Title, keywords or comments) when saving or exporting as PDF from Office applications is NOT supported.
- Only the following file extension types are currently supported for attachment checking:

- Office 2003 and 2007 supported applications (e.g. Doc and Docx). Note that support for 2003 requires an additional install action as described in the product Release Note.
- HTML
- Open Office
- PDF
- ZIP
- EML
- JPEG

Boldon James Tracing and Event logging

There is no Boldon James trace (BJTrace) application in the Mac environment.

By default, all logging is directed towards the system log, which can be viewed using the console application. However, this will not display the lower levels of Mac logging (INFO / DEBUG) which broadly cover the logging levels 'Data/Function entry/Function exit/Major/Minor'.

The entries within the logs are similar to those seen via the Windows Event log. In particular, the same event ids and categories are used.

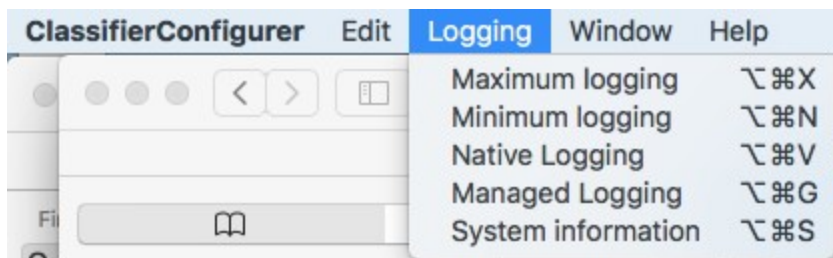

Logging levels are set from 1 to 7, with 7 being the most verbose, (==DEBUG); level 3 is sufficient for most logging requirements.

Selecting Maximum Logging automatically logs your components at a level 7; selecting Minimum Logging automatically logs your components at a level 1. The settings are actually stored in `/Library/Application Support/Boldon James/.com.boldonjames.BJTrace.plist`.

Managed Logging

Managed logging allows you to set the logging level for your managed user account.

1. From the Logging menu, select **Managed Logging**.
2. From the App IDs, select a classifier component.
3. Enter a name of the App ID.
4. Select a logging level from 1 to 7.
5. Enter the log file location. If a value is specified for this option, then the logging output will be appended to the file content. The file will be created if not present. However, any missing folders in the path will not be created, so you must ensure the folder path exists. We recommend using the default value provided; the log file will automatically appear in

the left-hand pane of the Console under the ~/Library/Logs area.

6. Click **Update**.

Native Logging

Native Loggings allows you to set the logging levels for Native Instruments.

1. From the Logging menu, select **Native Logging**.
2. Enter the Bundle Id.
3. Set the logging level.
4. In the **LogExtraFile** field, enter a string value, specifying the output file name. If you use the convention of the default value, with a folder path of ~/Library/Logs, and a file name extension of .log, then that log file should automatically appear in the left-hand pane of the Console under the ~/Library/Logs area.
5. Click **Update**.

NOTE: If using ~ in the path above, do not enclose the path name in double-quotes, as the results can be unpredictable.

Native logging (Sierra)

The Console application and logging behaviour has changed in Sierra. You can still create and save queries in the Console, using the 'Search' field and 'Save' button in the top right of the window.

However, it seems that 'standard' users cannot view the Log content in the Console as before.

A useful command-line utility called 'log' can be used to obtain more logging information. However, for some of the operations, the user has to be a member of the sudo group (which typically includes admin users).

To get MacClassifier logging displayed 'live' in a terminal window as a standard user on Sierra:

1. Ensure the defaults settings for MacClassifier have been set as described earlier.
2. Start Mac Classifier.
3. Open a terminal window.
4. Su to an admin user.
5. Run the following command: `Log stream -level info -predicate 'process contains "Mac Classifier"'`
6. Type in Control-C to stop the live streaming in the terminal window.
7. Select the 'Info' and 'Debug' logging levels from the Console 'Action' menu.
8. Run `sudo log` with various parameters to interrogate the logging database. Useful examples include:
 - `Sudo log collect --last 10m --output ~/Library/Logs/mylog.logarchive`
This example will save the last 10 minutes of logging to the specified file. Files with extension .logarchive can be viewed using the Console. Be aware that if you have switched to a different user to run the command, then the ~ will apply to that user's local store).

- `Log show --predicate 'process contains "Mac Classifier"' --last 30m-- info`
This example will output to the terminal window the last 30 minutes of logging from the Mac Classifier process, including info level messages. You can access the log help page using the command `log help`.

Native logging (High Sierra)

Using the Console, you can create queries to filter for logging items of interest.

If you right-click on a Mac Classifier entry and select show process 'Mac Classifier' from the menu, you can then save that query by clicking on the Save button near the top right of the Console.

You can further refine that filter; we recommend choosing the option to Hide Library 'AE' in order to get rid of a number of spurious Apple Event messages that may appear.

You can use the Action menu Include debug messages to display debug-level log messages in the Console.

Create and delete Diagnostics dictionary

To create a new Diagnostics dictionary section containing two settings in one operation use, use the command: `defaults write com.boldonjames.MacClassifier Diagnostics -dict LoggingLevel -int 7 LogFile -string ~/Library/Logs/macclassifier.log`

To delete a Diagnostics dictionary section, use the command: `defaults delete com.boldonjames.MacClassifier Diagnostics`.

Event Logging

On the Mac, the Boldon James Event Logging output is directed into a file named `~/Library/Logs/BoldonJamesEventLogging.log`. The file can be viewed using the Console application.

It contains the same information as output into the Windows event log by Windows Classifier, except that the event details are output as a block of XML following the 'General' event description.

Working with Windows Classifier Applications

Documents and emails classified using Mac Classifier will interwork with Windows Classifier and vice-versa. However, the fact that Outlook for Mac does not allow Mac Classifier to set an X-header property must be taken into account if interworking with Classifier Windows environments. For example, a label could be added as the First Line of Text (FLOT), or Exchange Classifier could be deployed.

There is no equivalent to File Classifier or Power Classifier in the Mac environment. But Classifier Word etc. will respond to any Refresh markings set by File Classifier under Windows.

See also [Label Propagation Mechanisms](#) for information on attachment type support.

Auditing Notes

- The Check rule Challenge dialog is shown, but the user's choice is not audited.
- A Save or Save As event will audit the name of the file at the time the action is invoked rather than the name of the file at the point it is actually saved (after the user has supplied a file name).